



LEVEL REGULATORS

Suitable for machines which request high precision or resistance of vibration, or huge machines; reinforcing the stability of the levels.



**TOP PHOENIX
INTERNATIONAL CORP.**
Machinery Exporter & Importer

No. 48-3, Wayao Rd., Dali Dist.,
Taichung City 412, Taiwan
E-Mail: sales@topphoenix.com.tw; topphoenix24@gmail.com;
top.phoenix@msa.hinet.net
<http://www.topphoenix.com.tw>
Tel: 886-4-2406-5028 (Rep.) Fax: 886-4-2406-5019

Sep. - 2021



本公司產品零件介紹

Introduce components of our company

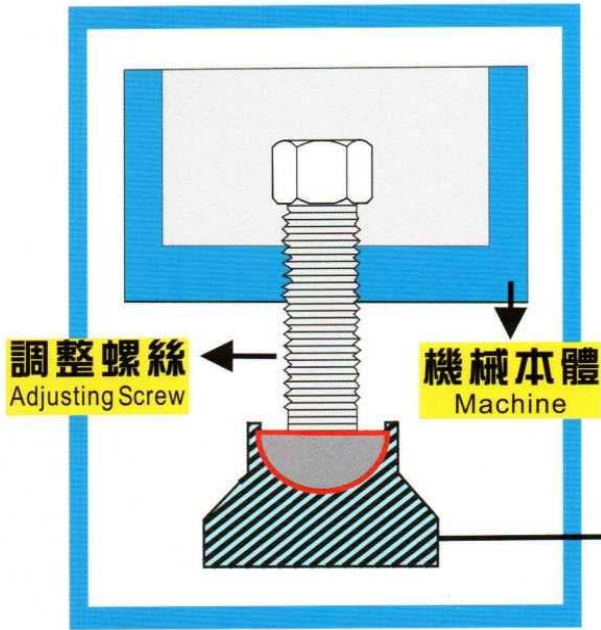

臥式水平調整器
Horizontal Level Regulator

立式水平調整座
Vertical Level Adjusting Base

強力麻花型地錨
Strong Braided Anchor

球型華司
Spherical Washer

延長桿
Extension Rod

立式水平調整座
Vertical Level Adjusting Base

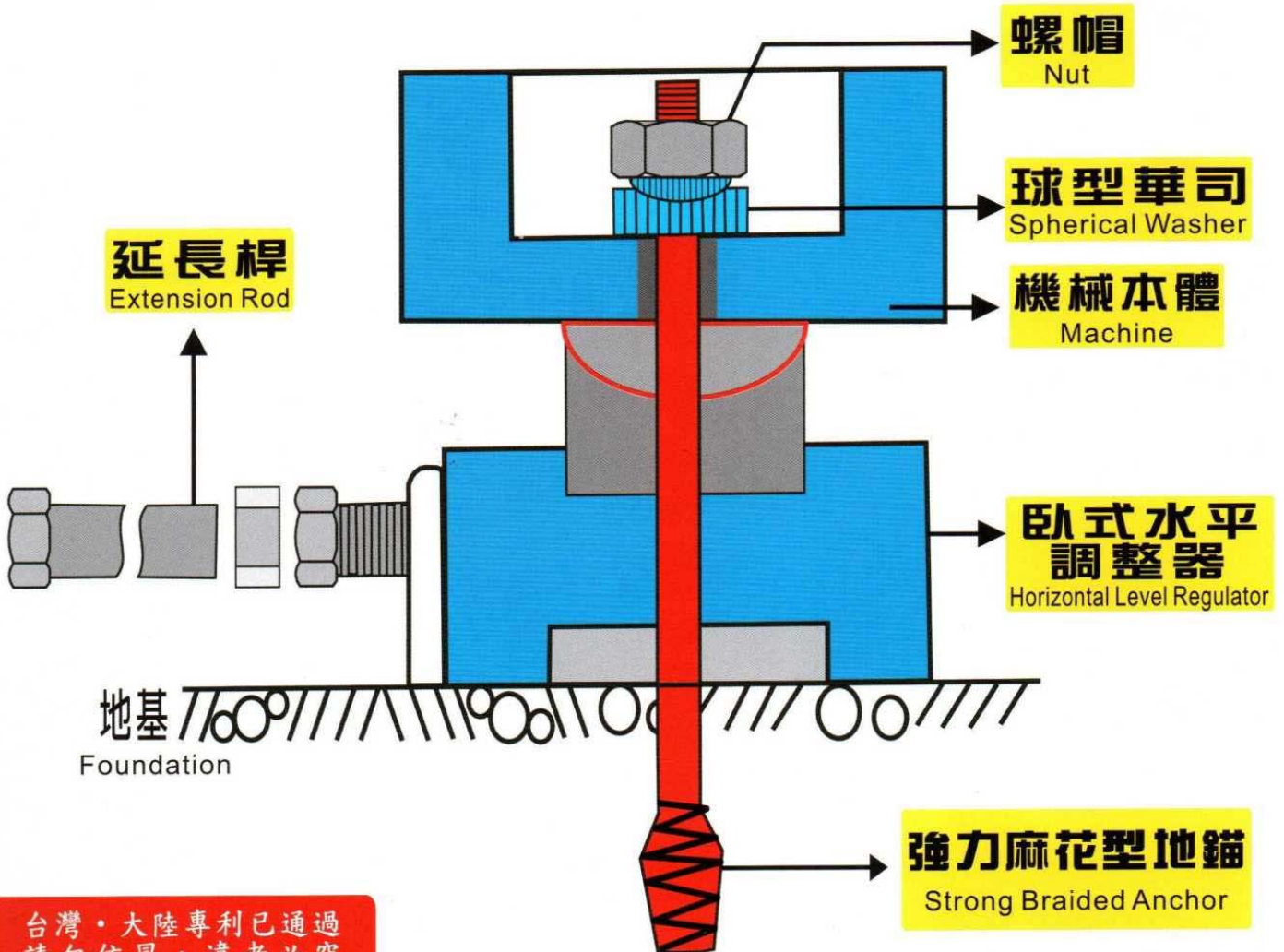

台灣·大陸專利已通過
請勿仿冒，違者必究
We have patent in Taiwan and China.
Do not copy. All rights reserved.

※任何款式皆可客製化訂製※
All products can be customized

臥式水平調整器 Horizontal Level Regulator

台灣·大陸專利已通過
請勿仿冒，違者必究
We have patent in Taiwan and China.
Do not copy. All rights reserved.

特點:一般機器使用(三片裝)

Feature: Suitable for general machine (Assembly of three units)

A型 Type A

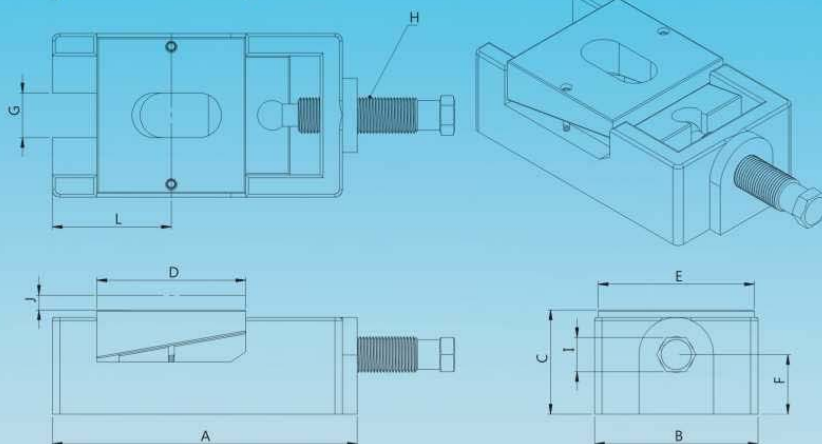

安裝圖

Installation diagram

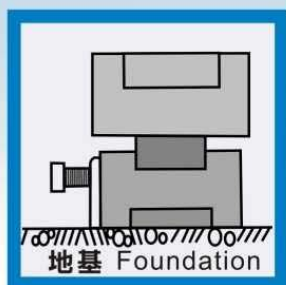

材質(Material): FC25、FCD45、SS400

單位(UNIT):MM

NO	LOAD	A	B	C	D	E	F	G	H	I	J	L
A-3	3T	160	80	55	80	85	28	25	M20 xP2	19	8	60
A-5	5T	205	105	60	100	105	30	30	M24 xP1.5	23	10	80
A-10	10T	205	110	70	100	105	40	30	M24 xP1.5	23	10	80
A-15	15T	230	150	80	120	140	44	45	M30 xP1.5	30	10	100
A-20	20T	320	200	105	150	200	48	50	M30 xP1.5	30	10	130

*此圖僅提供參考，以現品為準。

*The picture is for reference only, the actual is the standard.

*產品負荷平均且和緩，非瞬間或集中負載。

*The load of products is average and gentle, not instant or concentrated load.

臥式水平調整器 Horizontal Level Regulator

台灣·大陸專利已通過
請勿仿冒，違者必究
We have patent in Taiwan and China.
Do not copy. All rights reserved.

特點:配合地錨螺柱, 使用方便安裝(三片裝)

Feature: Coordinate with anchor. Easy to assemble (Assembly of three units)

B型 Type B

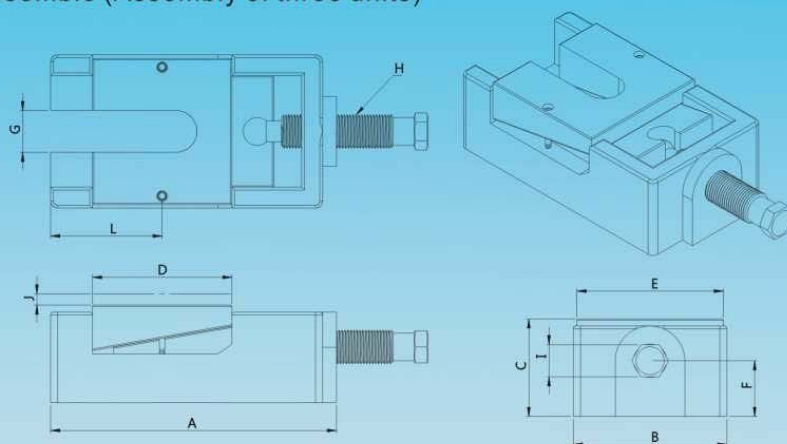

安裝圖

Installation diagram

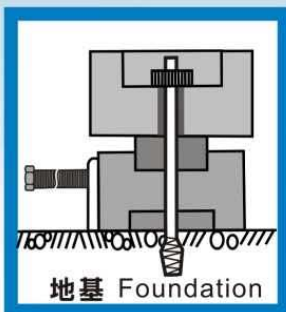

材質(Material): FC25、FCD45、SS400

單位(UNIT):MM

NO	LOAD	A	B	C	D	E	F	G	H	I	J	L
B-3	3T	160	80	55	80	85	28	25	M20 xP2	19	6	60
B-5	5T	205	105	60	100	105	30	30	M24 xP1.5	23	8	80
B-10	10T	205	110	70	100	105	40	30	M24 xP1.5	23	8	80
B-15	15T	230	150	80	120	140	44	45	M30 xP1.5	30	8	100
B-20	20T	320	200	105	150	200	48	50	M30 xP1.5	30	8	130

*此圖僅提供參考，以現品為準。

*The picture is for reference only, the actual is the standard.

*產品負荷平均且和緩，非瞬間或集中負載。

*The load of products is average and gentle, not instant or concentrated load.

臥式水平調整器 Horizontal Level Regulator

台灣·大陸專利已通過
請勿仿冒，違者必究
We have patent in Taiwan and China.
Do not copy. All rights reserved.

特點: 1. 地面不平時, 可保持全面接觸 (四片裝)
2. 適合高精度機器

Feature: 1. The regulator can be fully touch with uneven ground
2. Suitable for high precision machine
(Assembly of four units)

AU型 Type AU

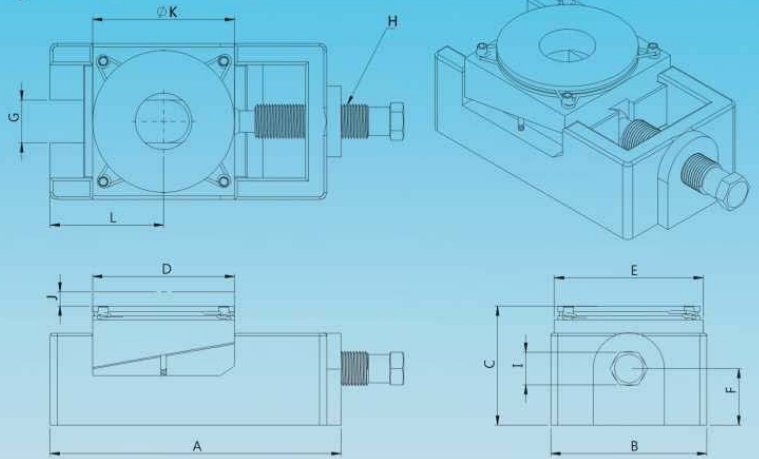

安裝圖

Installation diagram

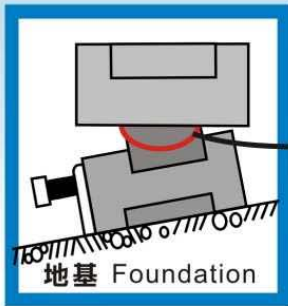

接觸面
contact surface

材質(Material): FC25、FCD45、SS400

單位(UNIT):MM

NO	LOAD	A	B	C	D	E	F	G	H	I	J	K	L
AU-3	3T	160	80	65	80	85	28	25	M20 xP2	19	8	80	60
AU-5	5T	205	105	74	100	105	30	30	M24 xP1.5	23	10	100	80
AU-10	10T	205	110	84	100	105	40	30	M24 xP1.5	23	10	100	80
AU-15	15T	230	150	90	120	140	44	45	M30 xP1.5	30	10	120	100
AU-20	20T	320	200	115	150	200	48	50	M30 xP1.5	30	10	150	130

*此圖僅提供參考, 以現品為準。

*The picture is for reference only, the actual is the standard.

*產品負荷平均且和緩, 非瞬間或集中負載。

*The load of products is average and gentle, not instant or concentrated load.

臥式水平調整器 Horizontal Level Regulator

台灣·大陸專利已通過
請勿仿冒，違者必究
We have patent in Taiwan and China.
Do not copy. All rights reserved.

特點: 1. 配合地錨螺栓使用方便
2. 地面不平時, 可保持全面接觸 (四片裝)
3. 適合高精度機器

Feature: 1. Coordinate with anchor. Easy to assemble
2. The regulator can be fully touch with uneven ground
3. Suitable for high precision machine
(Assembly of four units)

BU型 Type BU

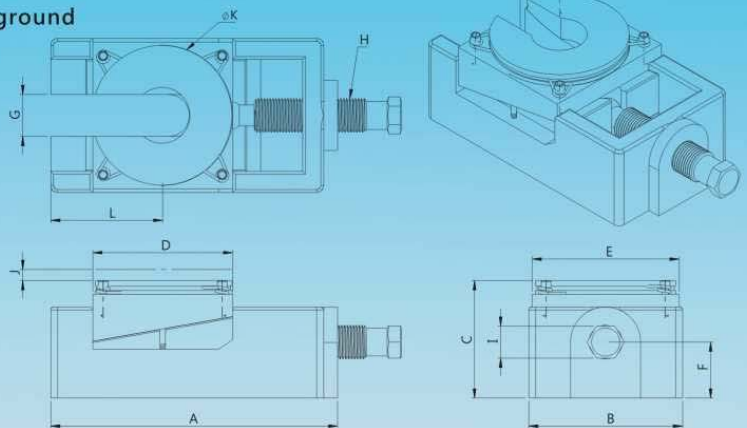

安裝圖

Installation diagram

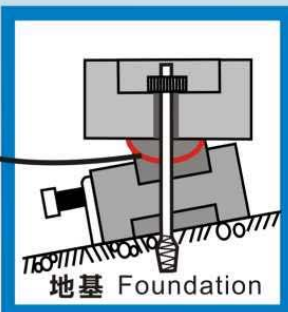

接觸面
contact surface

材質(Material): FC25、FCD45、SS400

單位(UNIT):MM

NO	LOAD	A	B	C	D	E	F	G	H	I	J	K	L
BU-3	3T	160	80	65	80	85	28	25	M20 xP2	19	6	80	60
BU-5	5T	205	105	74	100	105	30	30	M24 xP1.5	23	8	100	80
BU-10	10T	205	110	84	100	105	40	30	M24 xP1.5	23	8	100	80
BU-15	15T	230	150	90	120	140	44	45	M30 xP1.5	30	8	120	100
BU-20	20T	320	200	115	150	200	48	50	M30 xP1.5	30	8	150	130

*此圖僅提供參考, 以現品為準。

*The picture is for reference only, the actual is the standard.

*產品負荷平均且和緩, 非瞬間或集中負載。

*The load of products is average and gentle, not instant or concentrated load.

臥式水平調整器 Horizontal Level Regulator

台灣·大陸專利已通過
請勿仿冒，違者必究
We have patent in Taiwan and China.
Do not copy. All rights reserved.

特點:一般機器使用(三片裝)

Feature: Suitable for general machine (Assembly of three units)

SA型 Type SA

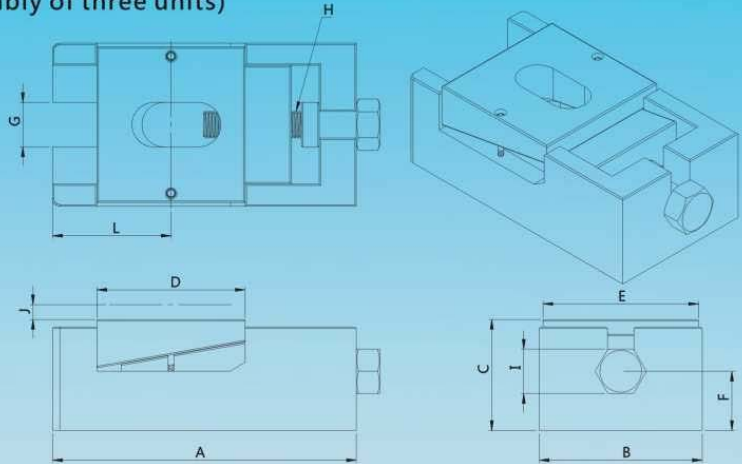

安裝圖

Installation diagram

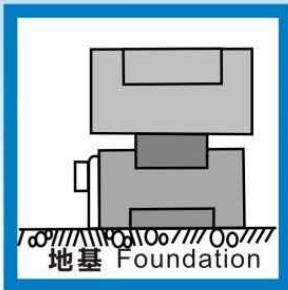

材質(Material): FC25、FCD45、SS400

單位(UNIT):MM

NO	LOAD	A	B	C	D	E	F	G	H	I	J	L
SA-3	3T	165	80	55	80	85	28	25	M16 xP2	27	8	65
SA-5	5T	205	105	65	100	105	30	30	M18 xP1.5	30	10	80
SA-10	10T	205	110	75	100	105	40	30	M18 xP1.5	30	10	80
SA-15	15T	230	150	80	120	140	44	45	M20 xP1.5	38	10	100
SA-20	20T	320	200	105	150	200	48	50	M24 xP1.5	38	10	130

*此圖僅提供參考，以現品為準。

*The picture is for reference only, the actual is the standard.

*產品負荷平均且和緩，非瞬間或集中負載。

*The load of products is average and gentle, not instant or concentrated load.

臥式水平調整器 Horizontal Level Regulator

台灣·大陸專利已通過
請勿仿冒，違者必究
We have patent in Taiwan and China.
Do not copy. All rights reserved.

特點:配合地錨螺栓, 使用方便安裝(三片裝)

Feature: Coordinate with anchor. Easy to assemble (Assembly of three units)

SB型 Type SB

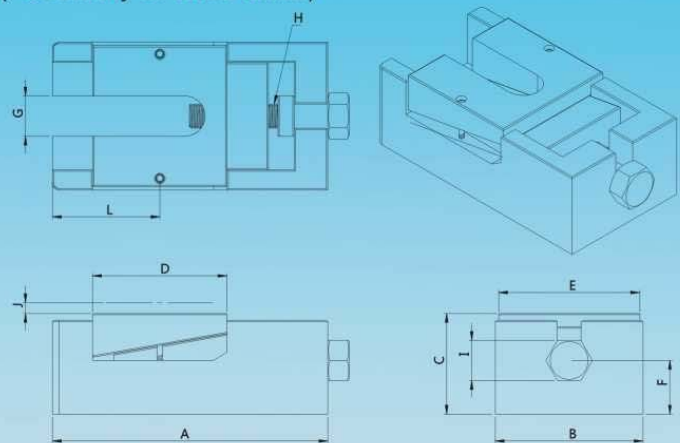

安裝圖

Installation diagram

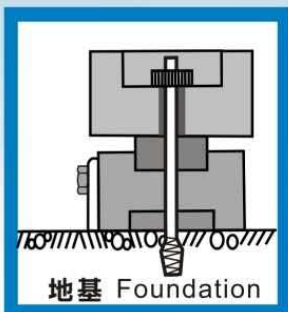

材質(Material): FC25、FCD45、SS400

單位(UNIT):MM

NO	LOAD	A	B	C	D	E	F	G	H	I	J	L
SB-3	3T	165	80	55	80	85	28	25	M16 xP2	27	6	65
SB-5	5T	205	105	65	100	105	30	30	M18 xP1.5	30	8	80
SB-10	10T	205	110	75	100	105	40	30	M18 xP1.5	30	8	80
SB-15	15T	230	150	80	120	140	44	45	M20 xP1.5	38	8	100
SB-20	20T	320	200	105	150	200	48	50	M24 xP1.5	38	8	130

*此圖僅提供參考，以現品為準。

*The picture is for reference only, the actual is the standard.

*產品負荷平均且和緩，非瞬間或集中負載。

*The load of products is average and gentle, not instant or concentrated load.

臥式水平調整器 Horizontal Level Regulator

台灣·大陸專利已通過
請勿仿冒，違者必究
We have patent in Taiwan and China.
Do not copy. All rights reserved.

- 特點:**
1. 配合地錨螺栓使用方便
 2. 地面不平時,可保持全面接觸(四片裝)
 3. 適合高精度機器

Feature:

1. Coordinate with anchor. Easy to assemble
2. The regulator can be fully touch with uneven ground
3. Suitable for high precision machine

SAU型 Type SAU

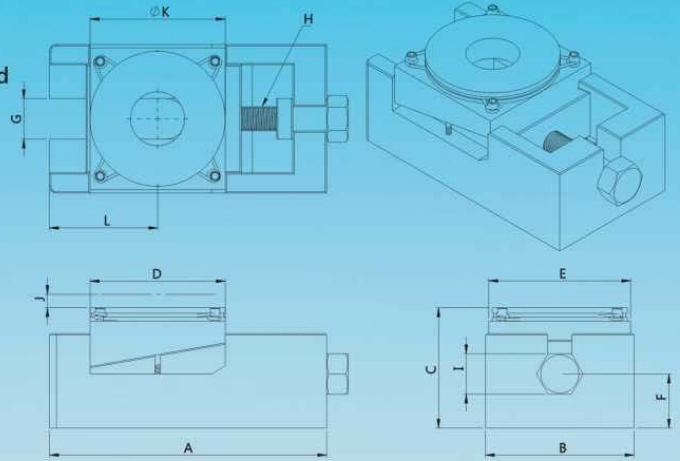

安裝圖

Installation diagram

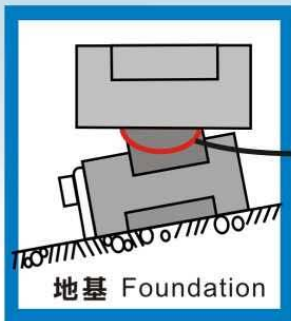

接觸面
contact surface

地基 Foundation

材質(Material): FC25、FCD45、SS400

單位(UNIT):MM

NO	LOAD	A	B	C	D	E	F	G	H	I	J	K	L
SAU-3	3T	165	80	65	80	85	28	25	M16 xP2	27	8	80	65
SAU-5	5T	205	105	79	100	105	30	30	M18 xP1.5	30	10	100	80
SAU-10	10T	205	110	89	100	105	40	30	M18 xP1.5	30	10	100	80
SAU-15	15T	230	150	90	120	140	44	45	M20 xP1.5	38	10	120	100
SAU-20	20T	320	200	115	150	200	48	50	M24 xP1.5	38	10	150	130

*此圖僅提供參考,以現品為準。

*The picture is for reference only, the actual is the standard.

*產品負荷平均且和緩,非瞬間或集中負載。

*The load of products is average and gentle, not instant or concentrated load.

臥式水平調整器 Horizontal Level Regulator

台灣·大陸專利已通過
請勿仿冒，違者必究
We have patent in Taiwan and China.
Do not copy. All rights reserved.

- 特點:**
1. 配合地錨螺栓使用方便
 2. 地面不平時,可保持全面接觸(四片裝)
 3. 適合高精度機器

Feature:

1. Coordinate with anchor. Easy to assemble
2. The regulator can be fully touch with uneven ground
3. Suitable for high precision machine

SBU型 Type SBU

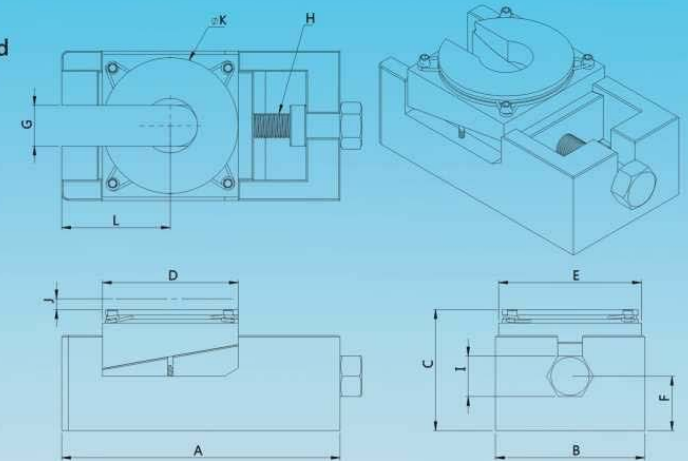

安裝圖

Installation diagram

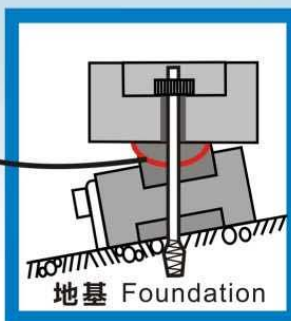

接觸面
contact surface

地基 Foundation

材質(Material): FC25、FCD45、SS400

單位(UNIT):MM

NO	LOAD	A	B	C	D	E	F	G	H	I	J	K	L
SBU-3	3T	165	80	65	80	85	28	25	M16 xP2	27	6	80	65
SBU-5	5T	205	105	79	100	105	30	30	M18 xP1.5	30	8	100	80
SBU-10	10T	205	110	89	100	105	40	30	M18 xP1.5	30	8	100	80
SBU-15	15T	230	150	90	120	140	44	45	M20 xP1.5	38	8	120	100
SBU-20	20T	320	200	115	150	200	48	50	M24 xP1.5	38	8	150	130

*此圖僅提供參考,以現品為準。

*The picture is for reference only, the actual is the standard.

*產品負荷平均且和緩,非瞬間或集中負載。

*The load of products is average and gentle, not instant or concentrated load.

臥式水平調整器 Horizontal Level Regulator

台灣·大陸專利已通過
請勿仿冒，違者必究
We have patent in Taiwan and China.
Do not copy. All rights reserved.

- 特點:** 1. 地面不平時,可保持全面接觸 (四片裝)
2. 適合高精度機器
3. 可作水平、垂直方向調整,固定機台

Feature: 1.The regulator can be fully touch with uneven ground
2.Suitable for high precision machine
3.Can be used to adjust the horizontal and vertical directions. Regulate machine

SAU-T型 Type SAU-T



安裝圖

Installation diagram

材質(Material): FC25、FCD45、SS400

單位(UNIT):MM

NO	LOAD	A	B	C	D	E	F	G	H	I	J	K	L
SAUT-10	10T	205	150	89	100	105	40	30	M18 xP1.5	30	10	100	80
SAUT-15	15T	230	150	90	120	140	44	45	M20 xP1.5	38	10	120	100
SAUT-20	20T	320	200	115	150	200	48	50	M24 xP1.5	38	10	150	130

*此圖僅提供參考,以現品為準。

*The picture is for reference only,the actual is the standard.

*產品負荷平均且和緩,非瞬間或集中負載。

*The load of products is average and gentle,not instant or concentrated load.

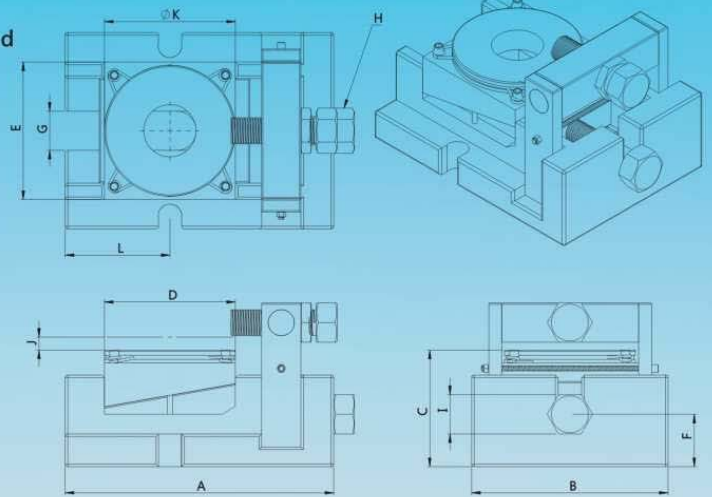
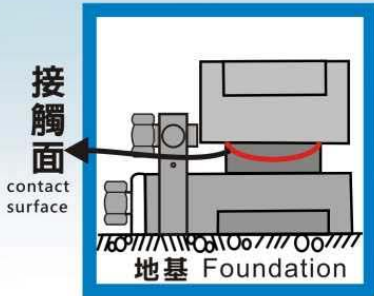

臥式水平調整器 Horizontal Level Regulator

台灣·大陸專利已通過
請勿仿冒，違者必究
We have patent in Taiwan and China.
Do not copy. All rights reserved.

- 特點:** 1. 地面不平時,可保持全面接觸 (四片裝)
2. 底部結合防震裝置,具有垂直、水平方向減震效果
3. 適合高精度機器

Feature: 1.The regulator can be fully touch with uneven ground (Assembly of four units)
2.Botton of the regulator combined with antivibrator for absorbing vertical and horizontal vibrations
3.Suitable for high precision machine

SAU-S型 Type SAU-S



安裝圖

Installation diagram

材質(Material): FC25、FCD45、SS400

單位(UNIT):MM

NO	LOAD	調整量 Adj. Range	備註 Re-Mark
SAU-S2	2T	7mm	附防震片 include shockproof attachment
SAU-S4	4T	7mm	

*此圖僅提供參考,以現品為準。

*The picture is for reference only,the actual is the standard.

*產品負荷平均且和緩,非瞬間或集中負載。

*The load of products is average and gentle,not instant or concentrated load.

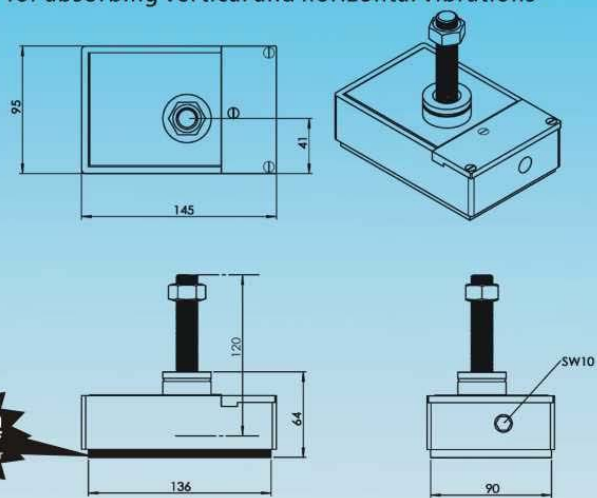
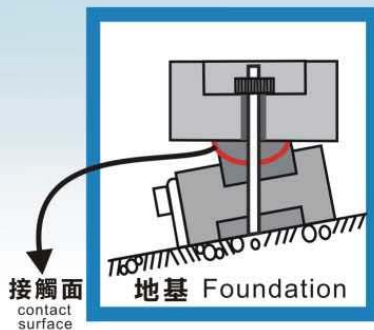

立式水平調整座 Vertical Level Adjusting Base

台灣·大陸專利已通過
請勿仿冒，違者必究
We have patent in Taiwan and China.
Do not copy. All rights reserved.

- 特點:** 1. 價格便宜, 穩定性佳 (兩片裝)
2. 可配合地錨使用, 安裝方便
3. 萬向接頭, 任何地面均可保持全面接觸
4. 適合中小型機械

- Feature:** 1. It is not expensive but stable (Assembly of two units)
2. Coordinate with anchor. Easy to assemble
3. Universal joint, fully touch with the ground
4. Suitable for Small and Medium machine

CA型 Type CA

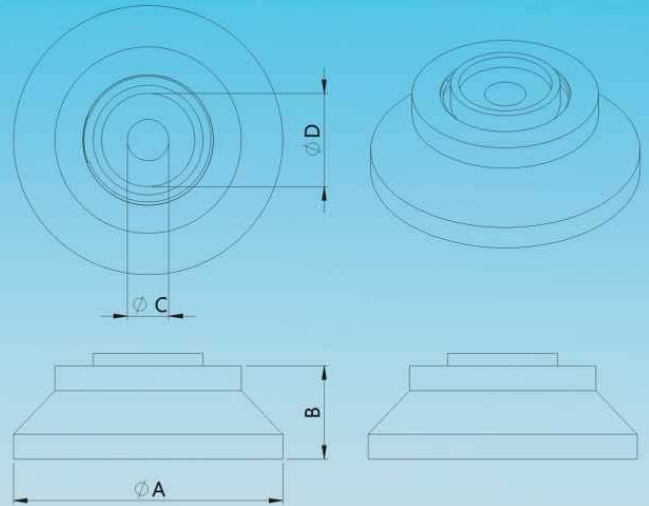

安裝圖

Installation diagram

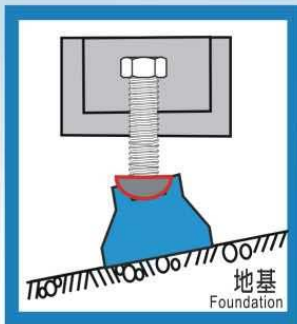

材質(Material): FC25、FCD45、SS400 單位(UNIT):MM

NO	A	B	C	D
CA-1	100	40	20	35
CA-2	130	45	20	45

*此圖僅提供參考，以現品為準。

*The picture is for reference only, the actual is the standard.

*產品負荷平均且和緩，非瞬間或集中負載。

*The load of products is average and gentle, not instant or concentrated load.

立式水平調整座 Vertical Level Adjusting Base

台灣·大陸專利已通過
請勿仿冒，違者必究
We have patent in Taiwan and China.
Do not copy. All rights reserved.

- 特點:** 1. 價格便宜, 穩定性佳 (兩片裝)
2. 可配合地錨使用, 安裝方便
3. 萬向接頭, 任何地面均可保持全面接觸
4. 適合中小型機械

- Feature:** 1. It is not expensive but stable (Assembly of two units)
2. Coordinate with anchor. Easy to assemble
3. Universal joint, fully touch with the ground
4. Suitable for Small and Medium machine

CB型 Type CB

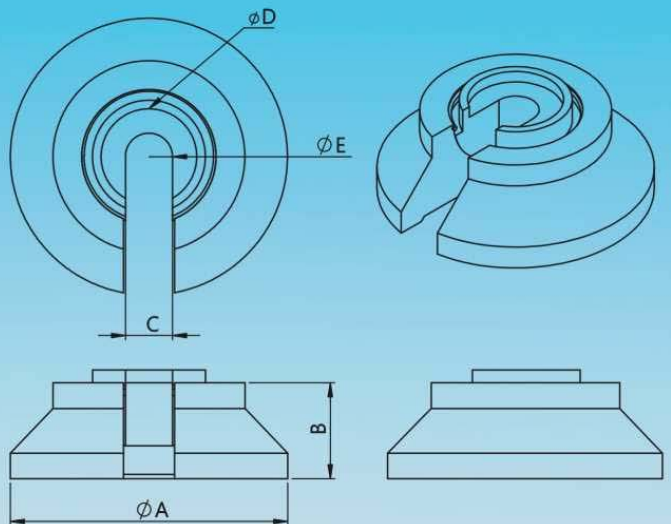

安裝圖

Installation diagram



材質(Material): FC25、FCD45、SS400 單位(UNIT):MM

NO	A	B	C	D	E
CB-1	100	40	18	35	18
CB-2	130	45	22	45	22

*此圖僅提供參考，以現品為準。

*The picture is for reference only, the actual is the standard.

*產品負荷平均且和緩，非瞬間或集中負載。

*The load of products is average and gentle, not instant or concentrated load.



- 特點:** 1. 特殊形狀, 軸向、徑向, 都具有優良抗拉力、抗扭力
2. 抗拉強度可達120kg/mm² 以上, 確保水平精度
3. 標準、特殊螺帽、螺紋均可訂製

Feature: 1.Special shape,axial,radial with excellent tensile strength and torsional resistance
2.Tensile strength up to more than 120kg/mm² Assure level accuracy
3.Standard and special nuts · bolts are customized

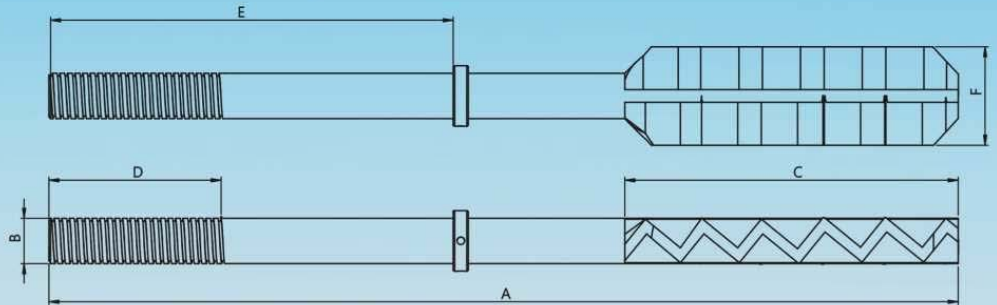

材質(Material): FCD45
單位(UNIT):MM

NO	A	B	C	D	E	F
AHx600M16	600以下	M16	170	120	Any size	45
AHx600M20	600以下	M20	170	120	Any size	45
AHx600M24	600以下	M24	170	120	Any size	45
AHx800M30	800以下	M30	220	120	Any size	65
AHx800M36	800以下	M36	220	150	Any size	65

*此圖僅提供參考, 以現品為準.

*The picture is for reference only,the actual is the standard.

*產品負荷平均且和緩, 非瞬間或集中負載.

*The load of products is average and gentle,
not instant or concentrated load.

各種配件

All kinds of accessories

1. 萬向華司

Universal Washer

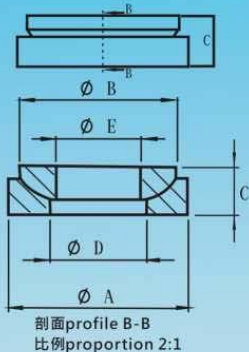

特點:
改善鎖緊螺帽與機器本體全面接觸
Feature:
Improve locknuts to fully touch with the machine

單位(UNIT):MM

NO	A	B	C	D	E
M16	36	36	11	23	21
M20	44	36	12	26	21
M24	54	48	17	28	26
M30	63	54	19	34	32
M36	78	68	21	40	38

材質(Material): FC25、FCD45、SS400

2. 延長桿(接頭.連桿.支撐架)

Extension Rod(joint.rod.support unit)

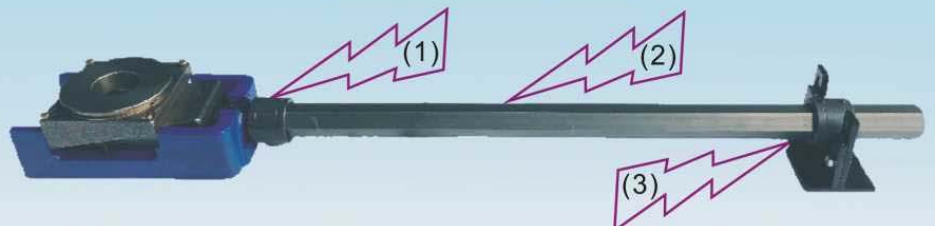
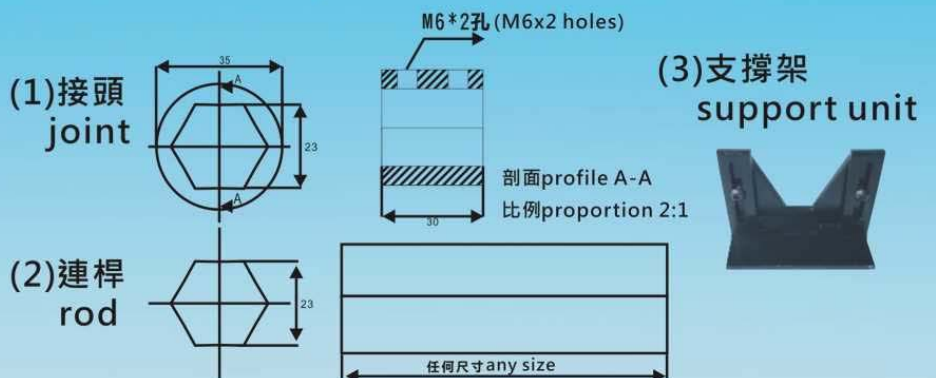

特點:
針對大型機械可延伸至中心
部份進行調整增加強度

Feature:
For the large machinery,
it can be extended to the central
to adjust and increase strength

*此圖僅提供參考, 以現品為準.

*The picture is for reference only,
the actual is the standard.

*產品負荷平均且和緩, 非瞬間或集中負載.

*The load of products is average and gentle,
not instant or concentrated load.